

➡ ZK28S05-30W Brick power supply

Wide voltage input
DC/DCBrick power supply

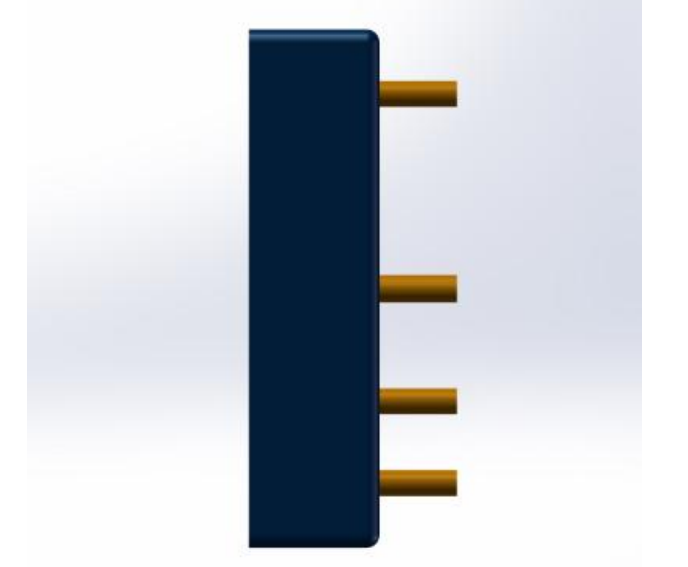
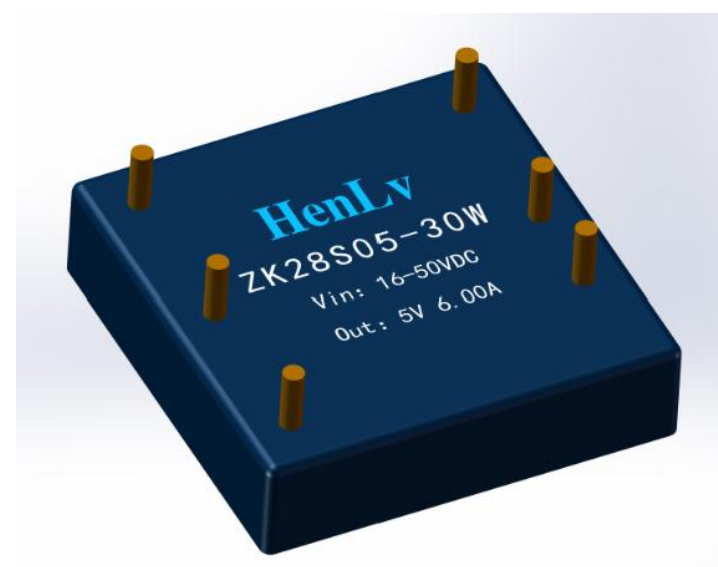

● Product features:

- ◎ Maximum output power 30W
- ◎ High power density: 195w / inch³
- ◎ Efficiency: 90%
- ◎ Isolation withstand voltage: 1500vdc 0.5mA 1minute
- ◎ Heat dissipation mode: natural cooling
- ◎ Wide voltage regulation range: 90% - 110% standard output voltage
- ◎ Pre bias voltage start / input over / under voltage protection, output over current protection / output over voltage protection / over temperature protection
- ◎ Logic control function
- ◎ Metal / plastic packaging, multiple installation options
- ◎ RoHS compliance
- ◎ Heat dissipation mode: natural cooling
- ◎ It has good shielding and anti-interference performance, electromagnetic compatibility, lightning protection, output over-current thermal protection, etc

Product overview:

- ◎ ZK28S05-30W brick power supply is the latest product developed by our company.
- ◎ This product has ultra wide input voltage of 16 ~ 50VDC, volume of 25.40 * 25.40 * 10.20, high efficiency and low power consumption. The product meets the requirements of green environmental protection, metal or plastic shell, with over-current, short circuit protection and other functions.

application area :

- ◎ Railway Communication
- ◎ monitor
- ◎ Monitoring equipment
- ◎ petrochemical industry
- ◎ Industrial control
- ◎ Long distance DC power supply system
- ◎ Switching system and communication equipment, etc

The company for customers to do any input and output of brick power supply, if you have special needs, please call our company, unless otherwise specified, the characteristics of brick power supply

It shall meet the requirements of Table 1 and be applicable to the full temperature range ($-40^{\circ}\text{C} \leq \text{TC} \leq +85^{\circ}\text{C}$)

Dimensions and pin mode

ZK28S05-30W

25.40*25.40*10.20 (mm)

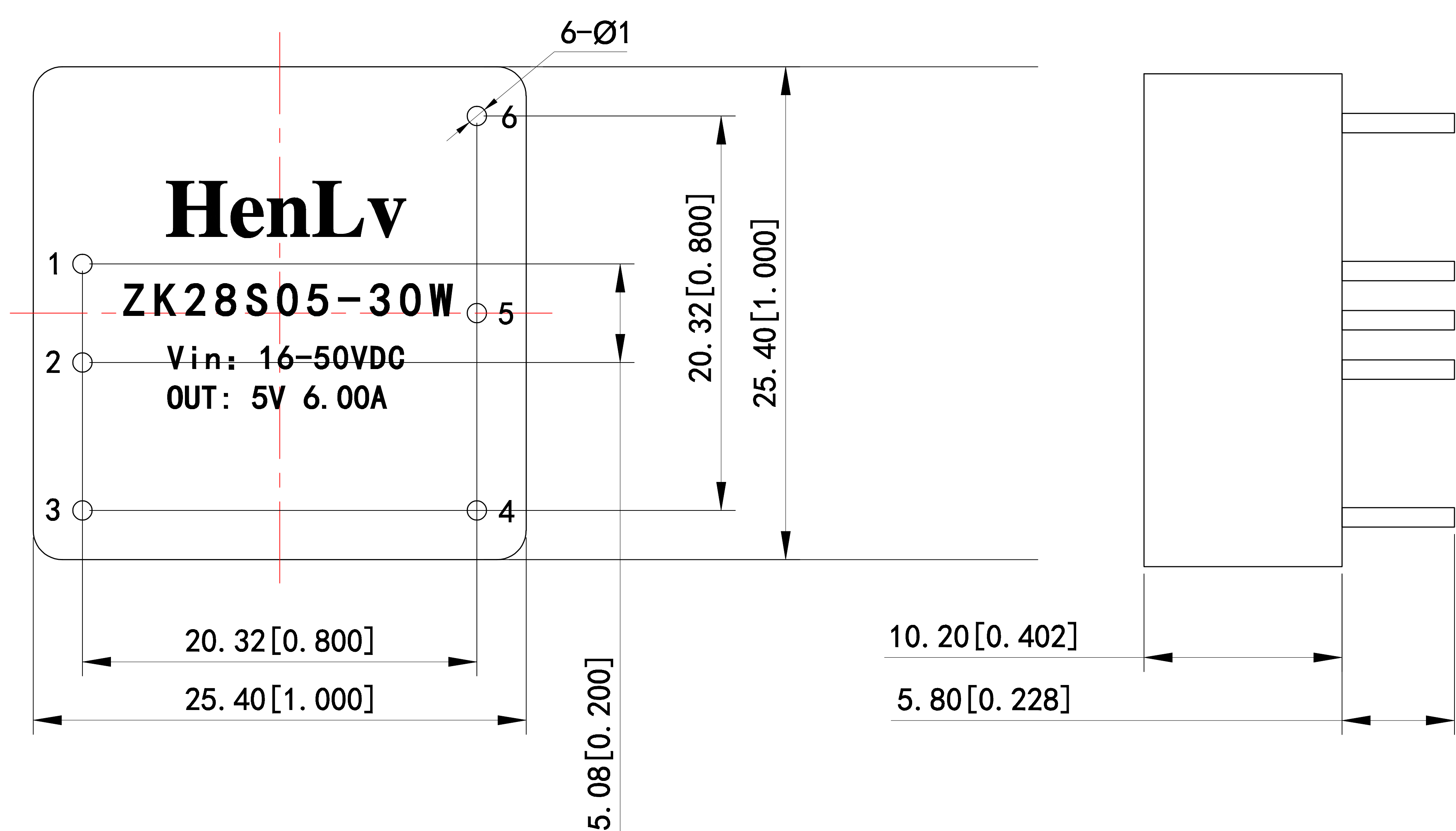

Definition of foot position

Pin	Function
1	Vin
2	GND
3	GNT
4	0V
5	TRM
6	+5VDC

The company for customers to do any input and output of brick power supply, if you have special needs, please call our company, unless otherwise specified, the characteristics of brick power supply
It shall meet the requirements of Table 1 and be applicable to the full temperature range (-40°C≤TC≤+85°C)

Series product parameters :

ZK28SXX-30W Series								
Model	input voltage	output voltage	Full load output current	efficiency	Isolation and withstand voltage	weight	encapsulation	authentication
ZK28S3.3-30W	16-50VDC	3.30VDC	9.00A	88.5%	1500VDC	—	DIP	ROHS
ZK28S05-30W	16-50VDC	5.00VDC	6.00A	90%	1500VDC	—	DIP	ROHS
ZK28S12-30W	16-50VDC	12.00VDC	2.50A	89%	1500VDC	—	DIP	ROHS

The company for customers to do any input and output of brick power supply, if you have special needs, please call our company, unless otherwise specified, the characteristics of brick power supply
It shall meet the requirements of Table 1 and be applicable to the full temperature range (-40℃≤TC≤+85℃)

Electrical characteristics

Electrical characteristics					
Electrical characteristics	Symbol	condition Unless otherwise specified Vi, -40℃≤TC≤+85℃	Limit value		Company
			minimum		
output voltage	Vo	the full load	Vo-2%Vo	Vo+2%Vo	V
Maximum output current	I omax	—	—	Po (output power) Uo (output voltage)	A
Output ripple voltage	VP-P	The full load, Vi, BW=20MHz Normal atmospheric temperature	50±10%	500±10%	mV
Voltage regulation rate	Sv	Vimin, VI, Vimax The full load	—	2. 00	%
Load adjustment rate	Si	Vi= (10%~100%) I omax	—	1. 00	%
efficiency	η	Vi, The full load Normal atmospheric temperature	80. 00	—	%
Safety regulation and electromagnetic compatibility	Magnetic field sensitivity test		GB-4943		
	Electrostatic discharge sensitivity test		GB-4943		
	Radiation sensitivity test		GB-4943		
	Conduction sensitivity test		GB-4943		
Temperature drift	0. 02%/℃				
frequency	50KZ~400KHZ(MAX)				
humidity	90% (MAX)				
Leakage current	NO				
MTBF	>50, 000Hour				

The company for customers to do any input and output of brick power supply, if you have special needs, please call our company, unless otherwise specified, the characteristics of brick power supply
It shall meet the requirements of Table 1 and be applicable to the full temperature range (-40℃≤TC≤+85℃)

Temperature curve, Error envelope curve

Typical efficiency curve

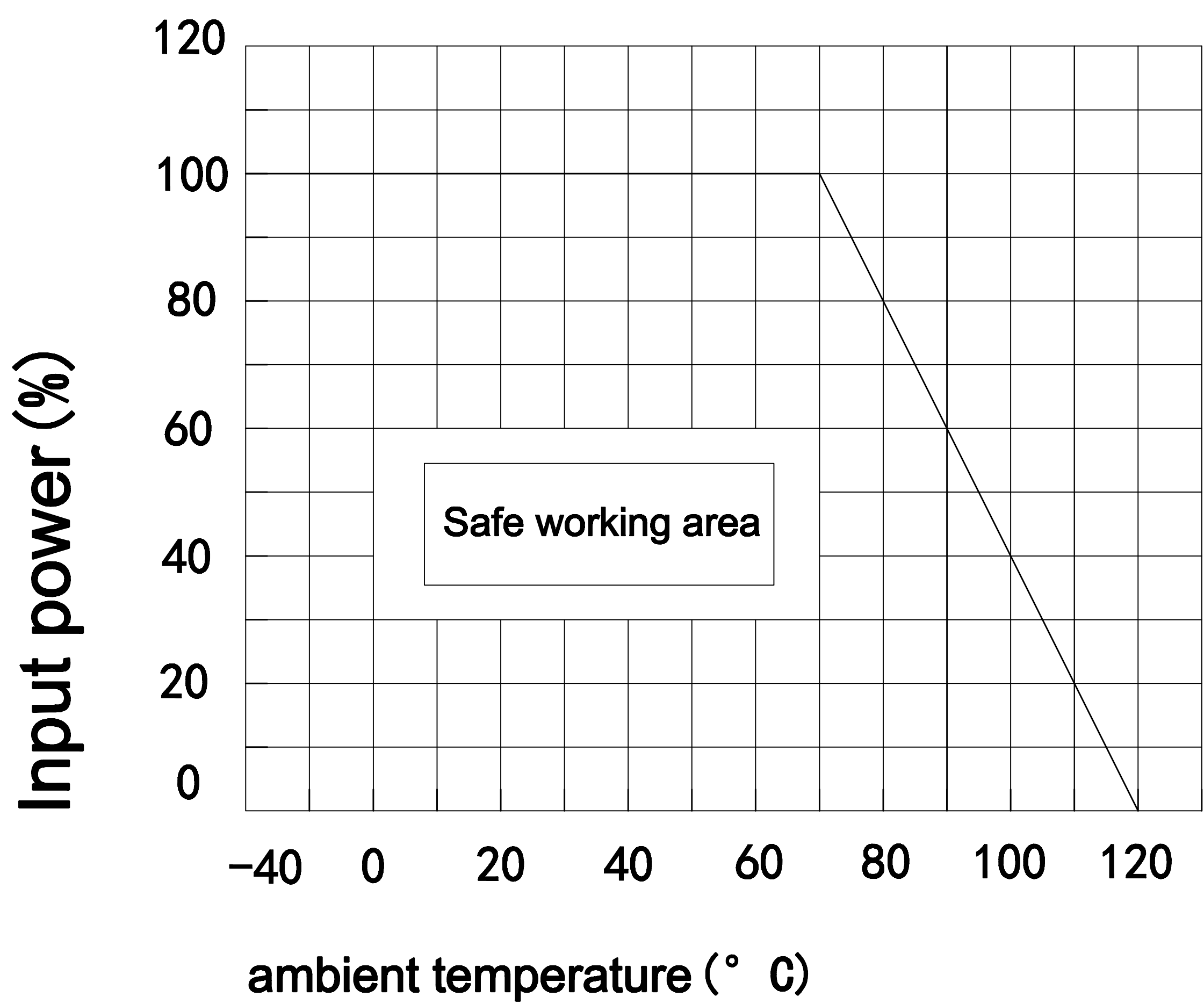

Temperature curve

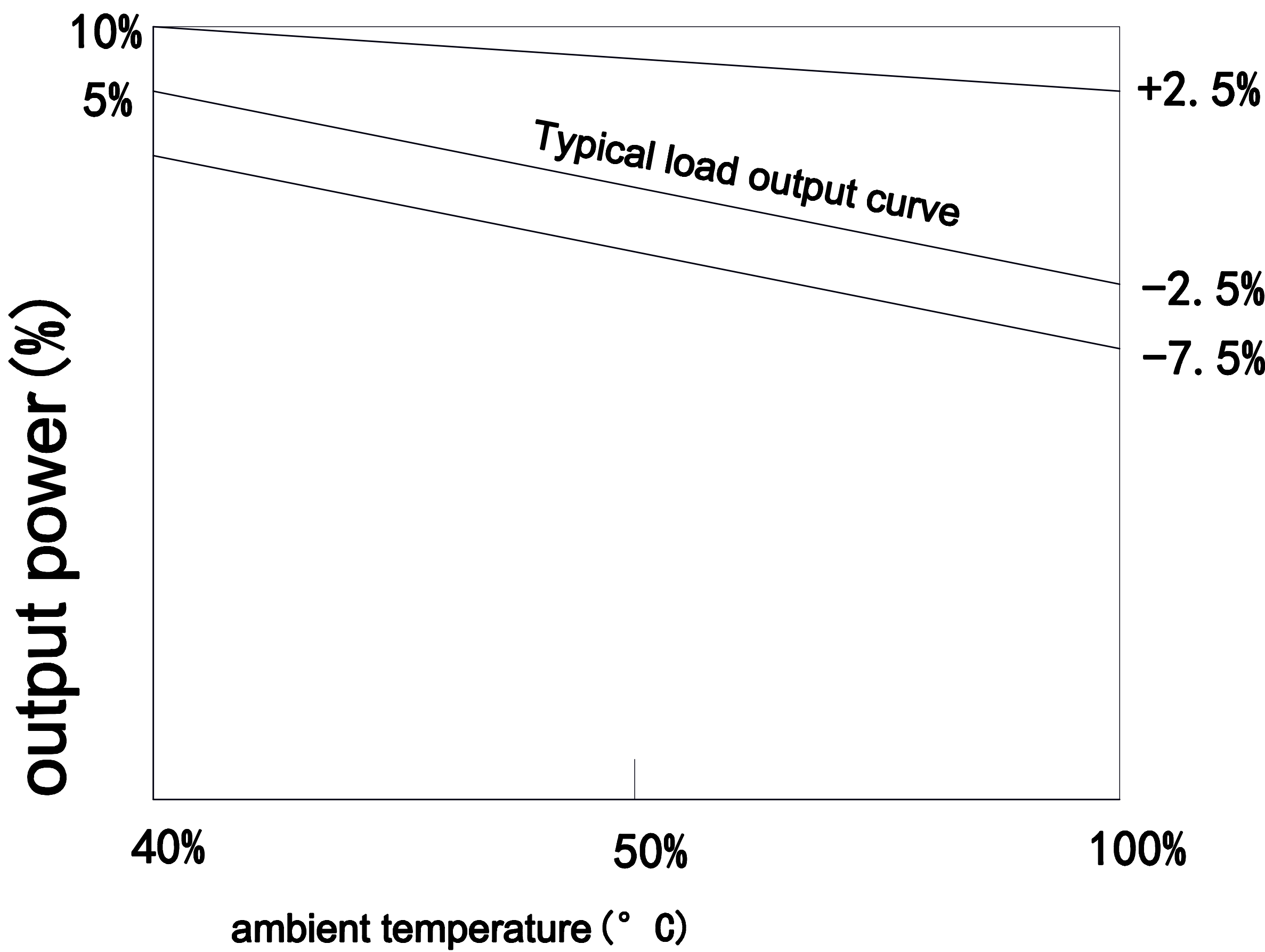

Safe working area

Error envelope curve

Typical efficiency curve

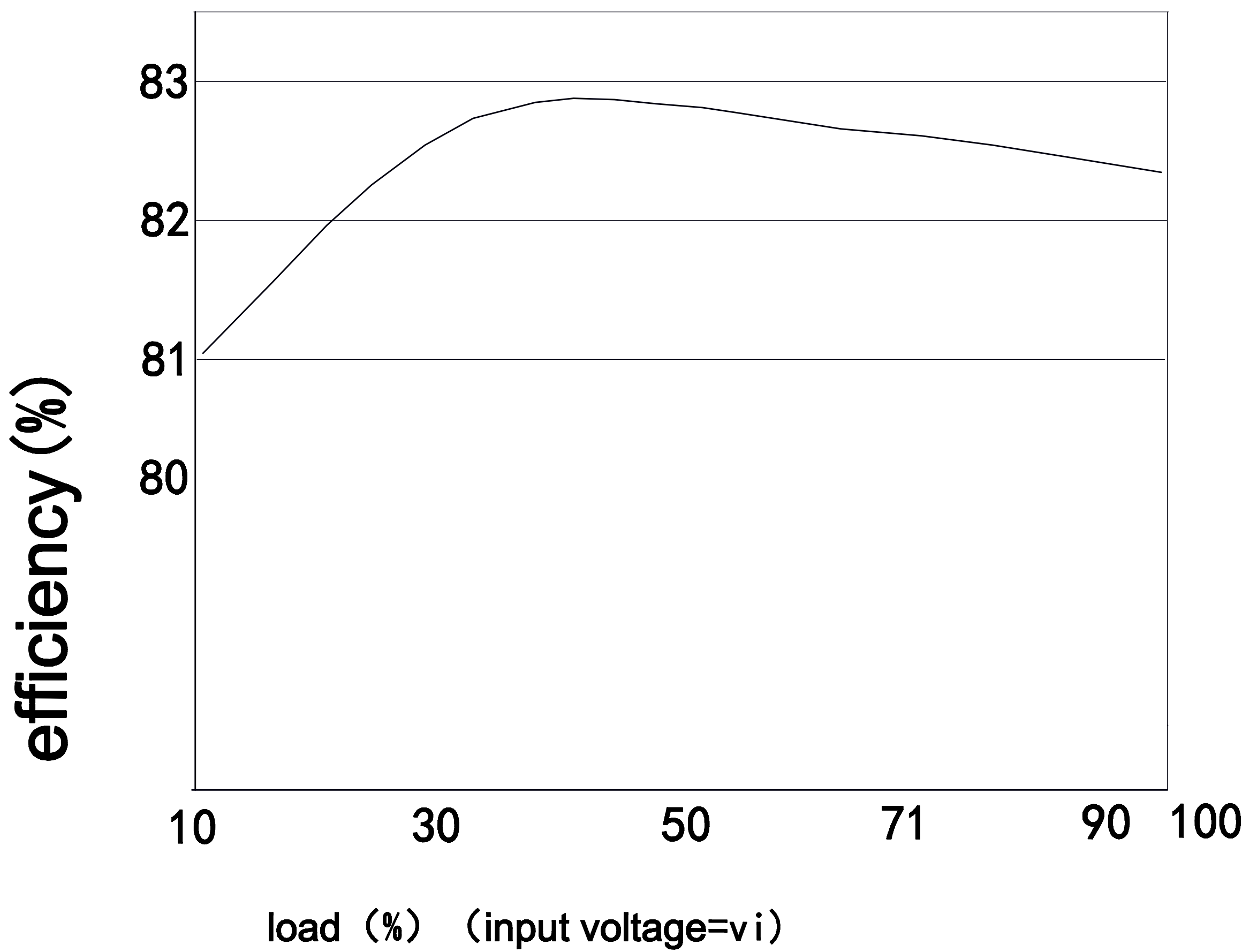

efficiency/Load curve

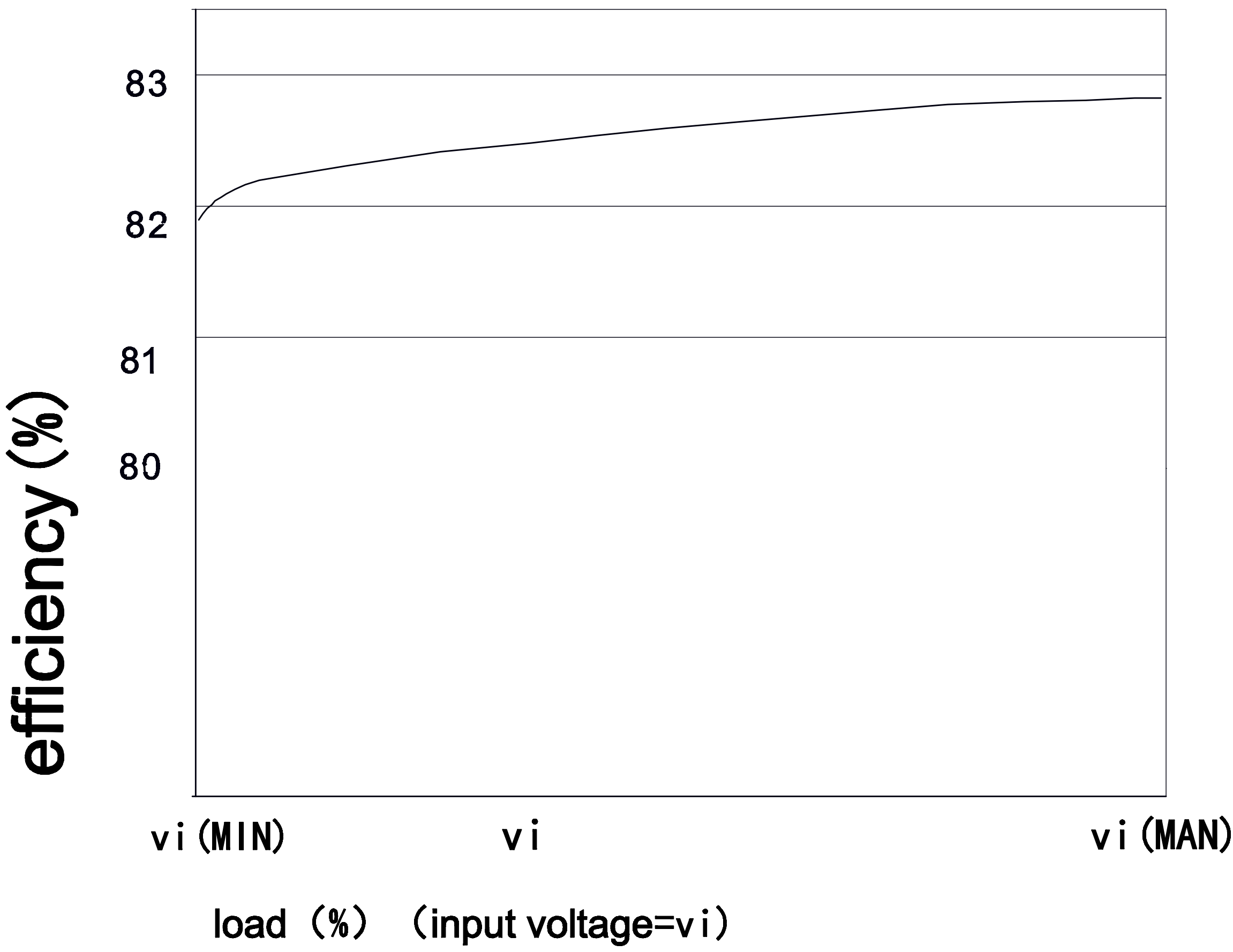

efficiency/Input voltage curve

The company for customers to do any input and output of brick power supply, if you have special needs, please call our company, unless otherwise specified, the characteristics of brick power supply
It shall meet the requirements of Table 1 and be applicable to the full temperature range $(-40^{\circ}\text{C}\leq\text{TC}\leq+85^{\circ}\text{C})$